

- NOTES:
1. MEASUREMENTS IN MILLIMETERS
 2. WORKMANSHIP IN ACCORDANCE WITH IPC-A-620 CLASS 2 AND IPC-A-610 CLASS 2.
 3. ALL PINS ARE SHORTED FOR SHIPPING.
 4. RESISTANCE PIN TO PIN, SHIELD AND JACKET SHALL BE $>10M\Omega$
 5. TRANSDUCERS ARE INSULATION TESTED TO 500 VDC. LEAD TO WATER RESISTANCE $>200 M\Omega$.
 6. TRANSDUCERS ARE PRESSURE RATED TO 2500 METERS.
 7. MAXIMUM DRIVE VOLTAGE: 300 Vrms.

REVISION HISTORY				
REV	DWN	APPR	DESCRIPTION	DATE

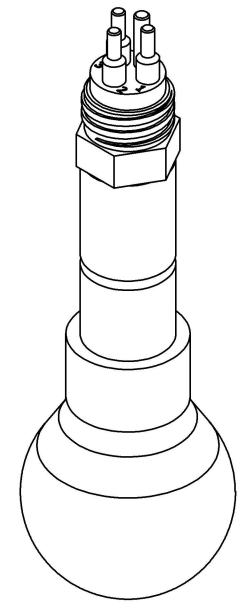
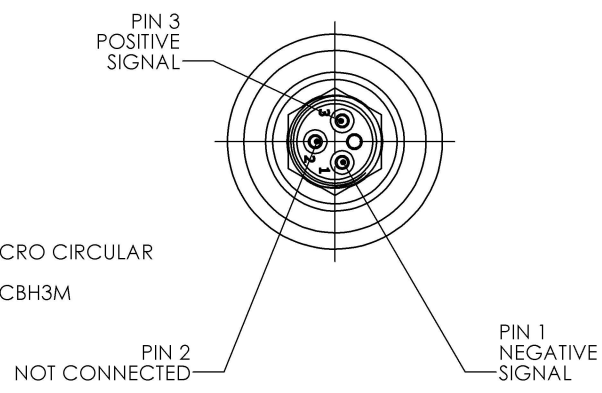
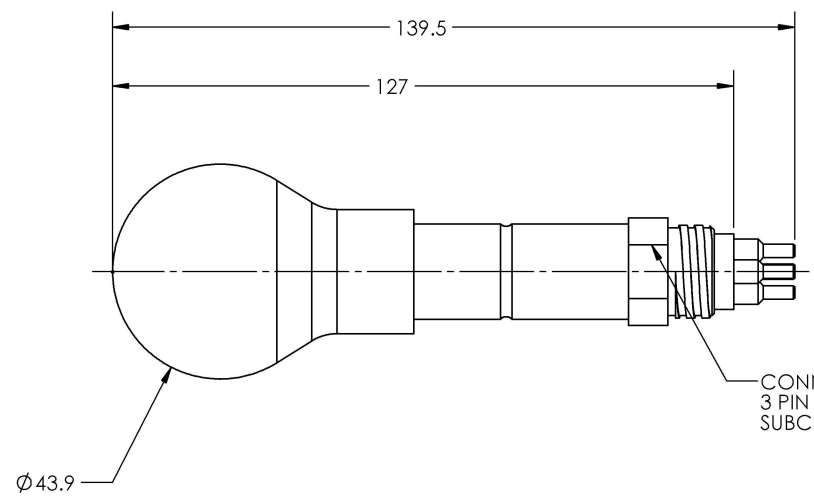

PROPRIETARY AND CONFIDENTIAL
 THE INFORMATION CONTAINED IN THIS DRAWING IS THE SOLE
 PROPERTY OF GEOSPECTRUM TECHNOLOGIES INC. ANY
 REPRODUCTION IN PART OR AS A WHOLE WITHOUT THE WRITTEN
 PERMISSION OF GEOSPECTRUM TECHNOLOGIES INC. IS PROHIBITED.

GTI **GeoSpectrum Technologies Inc.**
 10 Akerley Blvd., Unit 19 Tel: 1-902-406-4111
 Dartmouth, NS Fax: 1-902-435-8987
 Canada B3B 1J4 geospectrum.ca

DWN: NH	PRODUCT: M18-1.5	TITLE: M18C-1.5 MOUNTABLE SPHERE, PIN1-3
APPR: AH	SIZE: B	SCALE: 1:1
	SHEET: 1 of 1	DWG. No: 02-018-154
		DATE: 08 AUG 2024
		REV: 00